

GET READY TO LIVE YOUR BEST LIFE

With Smart, Adaptive Managed WiFi Service From Blue Stream Fiber

Our smart, Managed WiFi solution brings you reliably fast internet speeds and dependable connectivity for all of your devices all the time. Plus with the easy-to-use Plume HomePass App, you can monitor and manage the performance and connectivity of any device connected to your home network.



Blue Stream Managed WiFi Features

Adaptive WiFi™

Sends stronger signals to rooms where WiFi usage is higher and automatically provides a temporary speed boost when downloading large files.

Parental Controls

Allows for restricting access to certain online content and freezing WiFi access for devices. Set access rules at the device level, even for designated dates and times.

Guest Access

Gives you the ability to create guest networks and temporary passwords to control access to your home network. Whether it's the babysitter

or a weekend guest, you'll have complete control over who connects to your WiFi Network and how they use it.

AI Security™

Provides built-in IoT protection and device security against online attacks like malware and phishing. Advanced cybersecurity means you'll have ad blocking and automatic quarantining of compromised devices.

Total Control from the App

Our visually appealing and intuitive App allows you to enjoy the flexibility to monitor and control your home WiFi network whether you're at home or on the go.

Learn More

Discover how Managed WiFi from Blue Stream Fiber brings you a best-in-class WiFi experience. Open the camera on your mobile device and scan this QR code to get more details.



7 simple steps

The Homepass by Plume® gets subscribers up and running in minutes by connecting directly to the Plume Cloud, where Plume's Control™ service supports seamless customer self-installation, configuration, monitoring, and interaction.

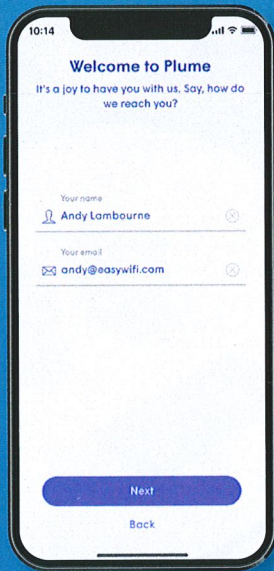

Step 1:
Create an account

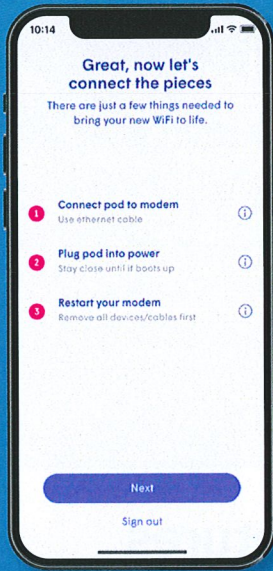

Step 2:
Get connected

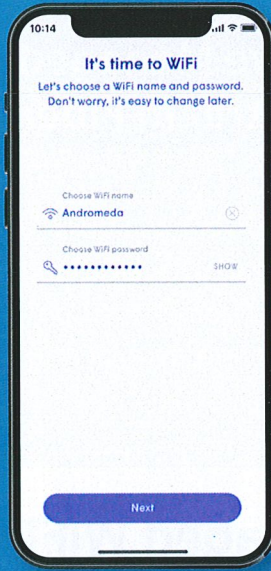

Step 3:
Set a WiFi name and password

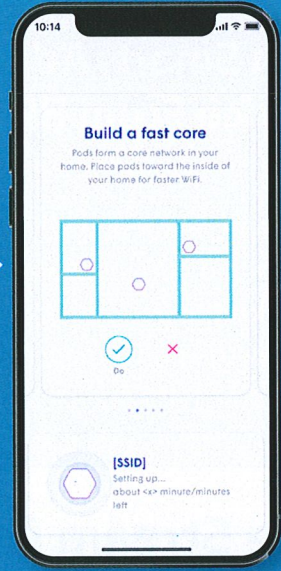

Step 4:
Place pods

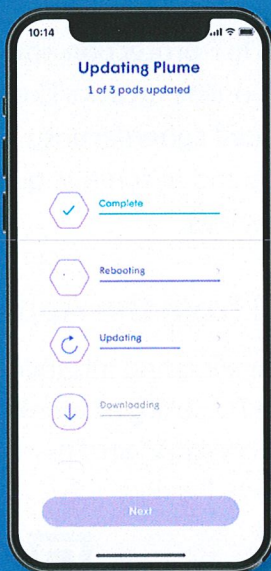

Step 5:
Automatic updates

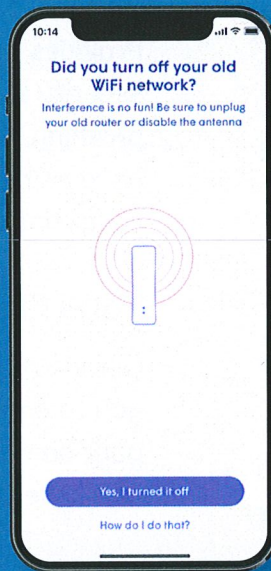

Step 6:
Out with the old

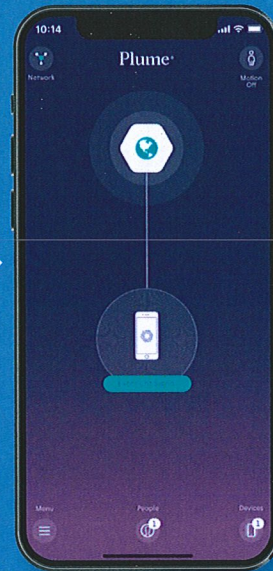

Step 7:
Complete the self-installation